

Avon Office

We are located just southeast of U.S. 36 and Dan Jones Road in Avon, only seven miles west of I-465.

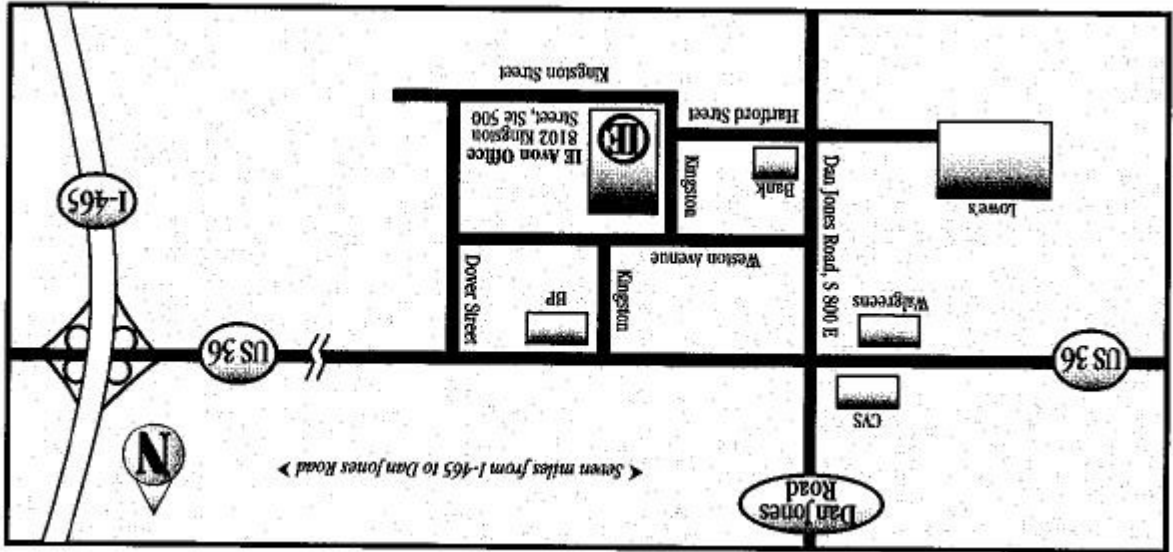

Indianapolis Office

We are located in the Triple A (AAA) building on the corner of 38th Street and Guion Road, just north of Westview Hospital.

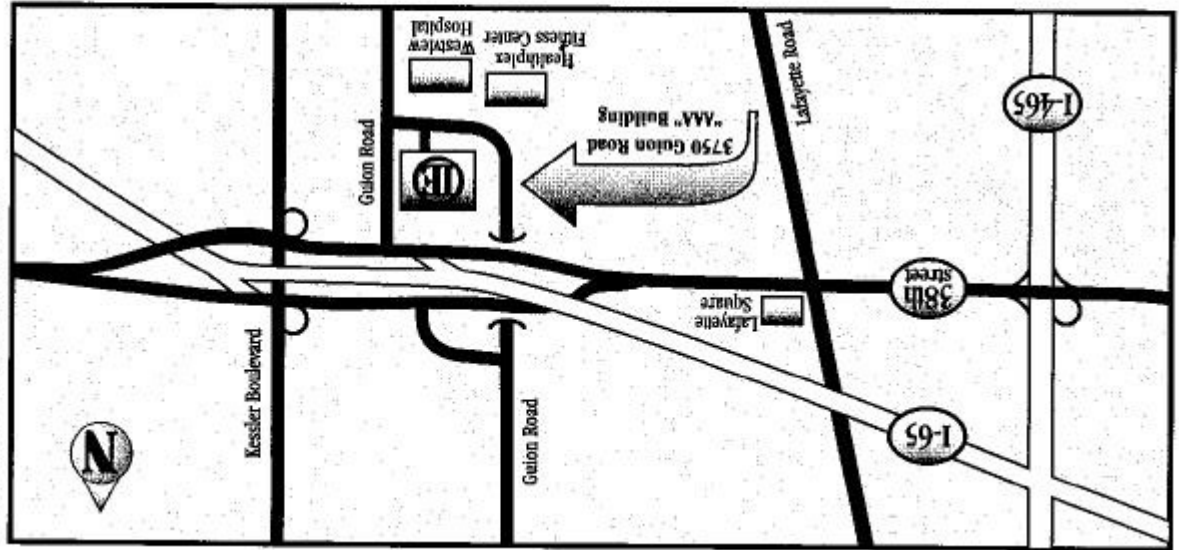

William R. Adams*, D.D.S., M.S.D. • Kenneth J. Spolnik*, D.D.S., M.S.D.
 Carl W. Newton*, D.D.S., M.S.D. • Kevin A. Deardorf, D.D.S., M.S.D.
 David H. Plotenhauer, D.D.S., M.S.D. • Benjamin H. Adams, D.D.S., M.S.D.
 Paul J. Ley, D.D.S., M.S.D.

Indianapolis Office Avon Office

3750 Guion Road, Suite 280 8102 Kingston Street, Suite 500
 Indianapolis, Indiana 46222 Avon, Indiana 46123
 (317) 924-3228 (317) 396-1873
 Fax (317) 924-3737 Fax (317) 279-2979

Practice Limited to Endodontics

Introducing _____ 20 _____

 Referred by Dr. _____
 Prepare Post Space Yes No
 Filling Yes No
 Electrospurg Yes No
 Band Yes No

MOLARS BICUS PIDS ANTERIORE BICUS PIDS MOLARS

	1	2	3	4	5	6	7	8	9	10	11	12	13	14	15	16	Upper
Right	32	31	30	29	28	27	26	25	24	23	22	21	20	19	18	17	Lower
																	Left

(CIRCLE TEETH FOR ENDODONTIC CONSIDERATION)

TO BE FILLED IN BY DENTIST

- Endodontics necessary for proper restoration.
- Pulp was exposed and was vital.
- Pulp was exposed and pulp was nonvital.
- Pulp was exposed and status of pulp couldn't be determined absolutely.
- Tooth is opened for drainage.
- X-ray revealed pulpal involvement.
- X-ray revealed radiolucency.
- Patient has vague toothache; please evaluate.
- Patient has pain, swelling or sensitivity; please evaluate.
- Other _____